

# DCR range, Developed to give you more.

---



D  
C  
R

INFRANOR SA  
Althardstrasse 158  
CH-8105 Regensdorf  
Switzerland

Phone: +41 (0)44 308 50 00  
[www.infranor.com](http://www.infranor.com)

# DCR range, a wide range of spans.

And just as Infranor enables SMEs to access the benefits of automation, OEM manufacturers can reach a wider audience through technological development.

Our teams of automation engineers, application experts, software developers, channel partners and support services will all be on hand to help you deploy your Cobot.

Our proven technologies help manufacturers get the most out of their operations.



# The automation power brought to you.

Infranor enables manufacturers of all sizes to make the most of flexible automation, whether to increase throughput, improve part quality or enhance quality, or boosting their company's capacity and competitiveness.

What are you looking to automate?

Whether you're looking to boost your business, increase margins or improve revenue growth, Infranor has the solution.

Infranor has designed the DCR Cobot range to turn your business challenges into collaborative robotic solutions.



## Discover the collaborative Robots Product Line



DCR-700-3-6



DCR-1000-5-6



DCR-1100-8-6



DCR-1300-10-6



DCR-1000-15-6



DCR-1700-20-6

Weight  
16kg

Weight  
27kg

Weight  
30kg

Weight  
38kg

Weight  
32kg

Weight  
65kg

Payload  
3kg

Payload  
5kg

Payload  
8kg

Payload  
10kg

Payload  
15kg

Payload  
20kg

Reach  
700mm

Reach  
1000mm

Reach  
1100mm

Reach  
1300mm

Reach  
1000mm

Reach  
1700mm

# Core Functional Components



Encoders



Control System



Electromagnetic quick-change modules



End-actuators



Brake mechanism



Six-Dimensional Torque Sensor



Frameless torque motors



Integrated Joint Module



Harmonic reducer



Large hollow low voltage drive



Easy Installation: The low dead weight makes installation quick and easy.

Safe and reliable: meet the requirements of human-machine co-operation, without the need for fences.

Low power consumption: about 200 watts.

Low total cost of ownership.

Multi-purpose, adapting to different scenarios



Structure

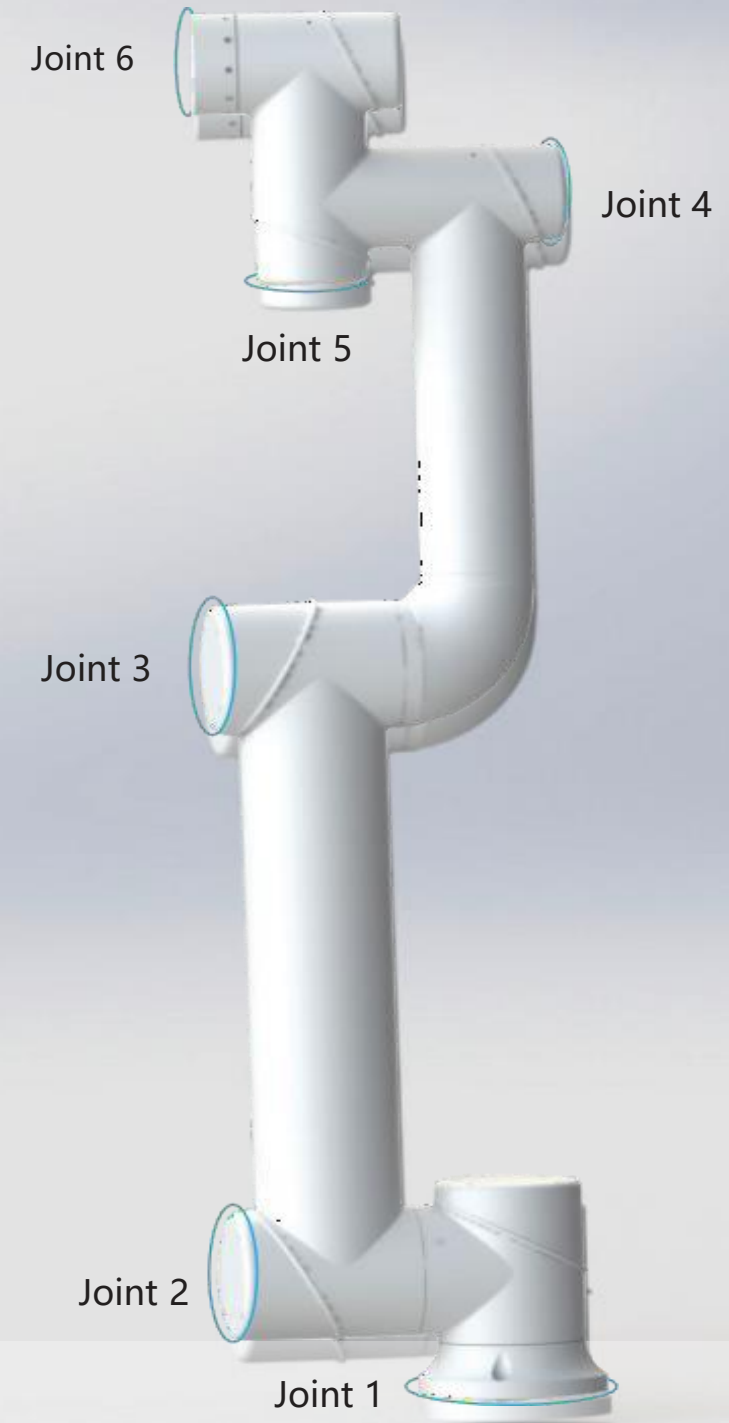

# Specifications

	DCR-700-3-6		DCR-1000-5-6		DCR-1100-8-6			DCR-1300-10-6		DCR-1000-15-6		DCR-1700-20-6	
Weight	16KG		24KG		30KG			38KG		32KG		65KG	
Payload	3KG		5KG		8KG			10KG		15KG		20KG	
Reach	700		1000		1100			1300		1000		1700	
Degrees of freedom	6		6		6			6		6		6	
Repeat Positioning Accuracy	±0.02		±0.03		±0.03			±0.03		±0.03		±0.05	
IP Class	Ip54		Ip54		Ip54			Ip54		Ip54		Ip54	
Sensors	six-dimensional torque sensor		six-dimensional torque sensor		six-dimensional torque sensor			six-dimensional torque sensor		six-dimensional torque sensor		six-dimensional torque sensor	
I/O	2 inputs, 2 outputs		2 inputs, 2 outputs		2 inputs, 2 outputs			2 inputs, 2 outputs		2 inputs, 2 outputs		2 inputs, 2 outputs	
End actuator velocity	<2m/s		<2m/s		<2m/s			<2m/s		<2m/s		<2m/s	
Field bus	Ethercat		Ethercat		Ethercat			Ethercat		Ethercat		Ethercat	
Voltage	48DC		48DC		48DC			48DC		48DC		48DC	
Installation	Floor-mounted, inverted, cantilevered		Floor-mounted, inverted, cantilevered		Floor-mounted, inverted, cantilevered			Floor-mounted, inverted, cantilevered		Floor-mounted, inverted, cantilevered		Floor-mounted, inverted, cantilevered	
Axis	Working range	Maximun speed	Working range	Maximun speed	Working range	Maximun speed		Working range	Maximun speed	Working range	Maximun speed	Working range	Maximun speed
Joint 1	±180°	180°/s	±180°	125°/s	±180°	125°/s		±180°	125°/s	±180°	125°/s	±180°	125°/s
Joint 2	±180°	180°/s	±180°	125°/s	±180°	125°/s		±180°	125°/s	±180°	125°/s	±180°	125°/s
Joint 3	±180°	180°/s	±180°	180°/s	±180°	125°/s		±180°	125°/s	±180°	125°/s	±180°	125°/s
Joint 4	±180°	200°/s	±180°	200°/s	±180°	180°/s		±180°	180°/s	±180°	200°/s	±180°	180°/s
Joint 5	±180°	200°/s	±180°	200°/s	±180°	180°/s		±180°	180°/s	±180°	200°/s	±180°	180°/s
Joint 6	±180°	200°/s	±180°	200°/s	±180°	180°/s		±180°	180°/s	±180°	200°/s	±180°	180°/s



# Collaborative Robot Dimension Drawings

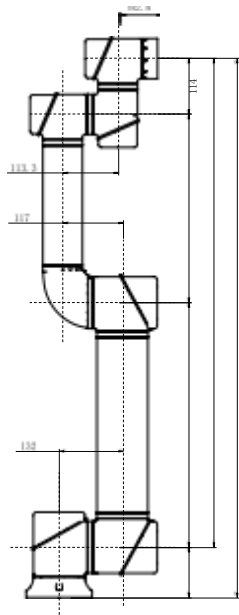

DCR-700-3-6

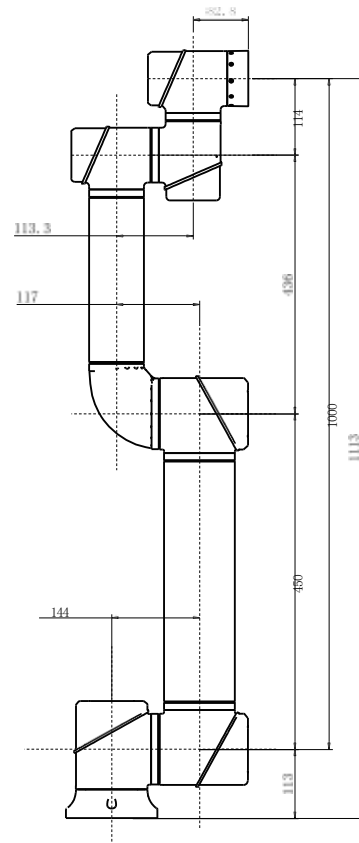

DCR-1000-5-6

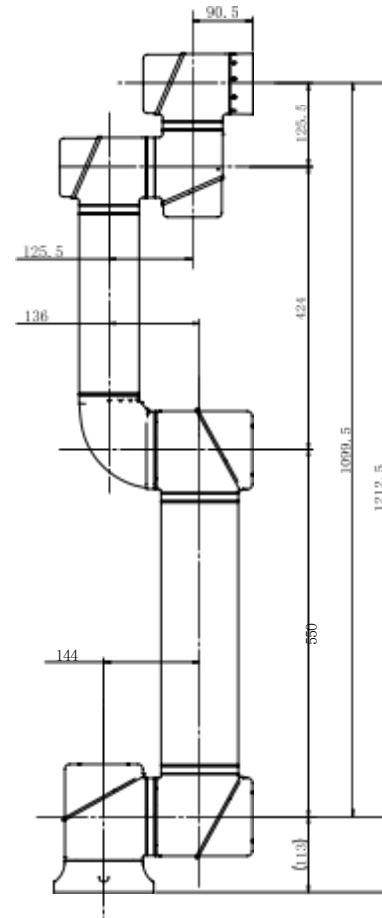

DCR-1100-8-6

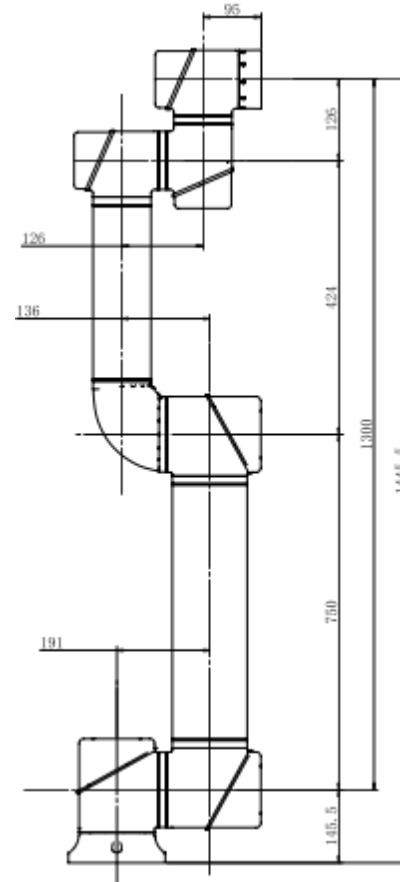

DCR-1300-10-6

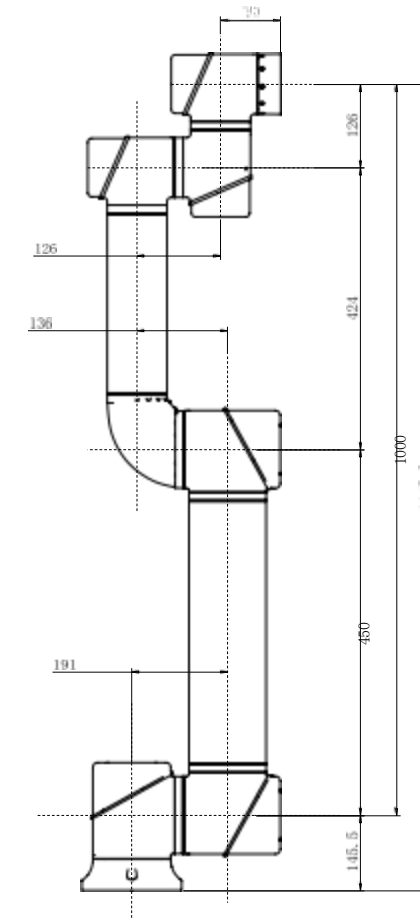

DCR-1000-15-6

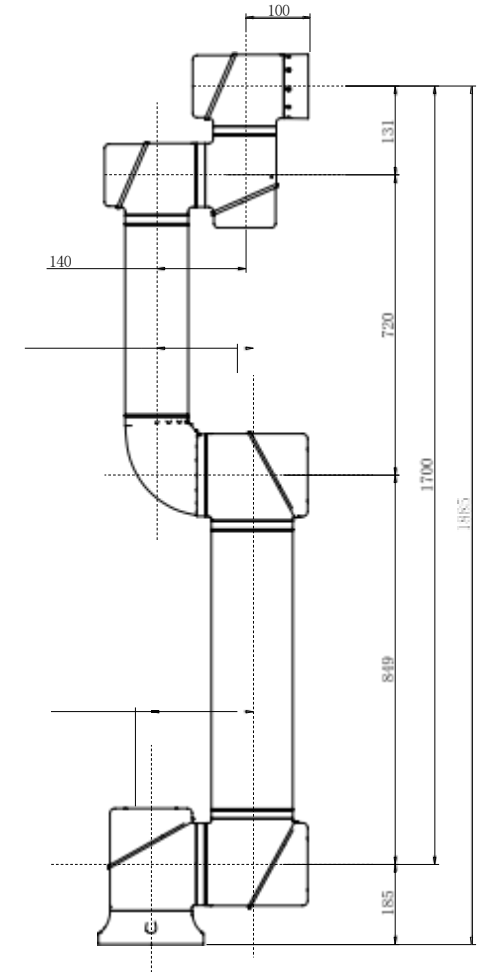

DCR-1700-20-6

A complex network diagram with numerous nodes of varying sizes and colors (teal, grey, light blue) connected by thin lines, set against a white background.

**Based on independent technological innovation**

**Serving Global Advanced Manufacturing**